



# LITTLE ROCK AIR FORCE BASE OUTDOOR RECREATION



## RV CAMPER EQUIPMENT GUIDE



# RENTAL INFORMATION

- **The full rental fee must be paid to reserve all campers.**
- **A copy of the responsible party's driver's insurance is required before, or at, pick-up.**
- **A cleaning/damage deposit of \$200 must be paid upon pick-up of equipment.**
- **Deposits will be returned by upon return of equipment to the responsible party, after it has been checked for cleanliness and damage by Outdoor Recreation staff.**
- **Deposit deductions may exceed \$200, if the bounce house is returned excessively damaged.**
- **Deposit Deduction Examples:**
  - **Trash, Dirt, or Grass Left inside of Camper**
  - **Water and Sewage Tanks Not Emptied**
  - **Damage to the Camper**
- **For further questions or details, contact Outdoor Recreation.**





# SALEM FSX 179DBK



DAILY: \$125  
WEEKEND: \$190  
HOLIDAY: \$260

# SALEM FSX 179DBK

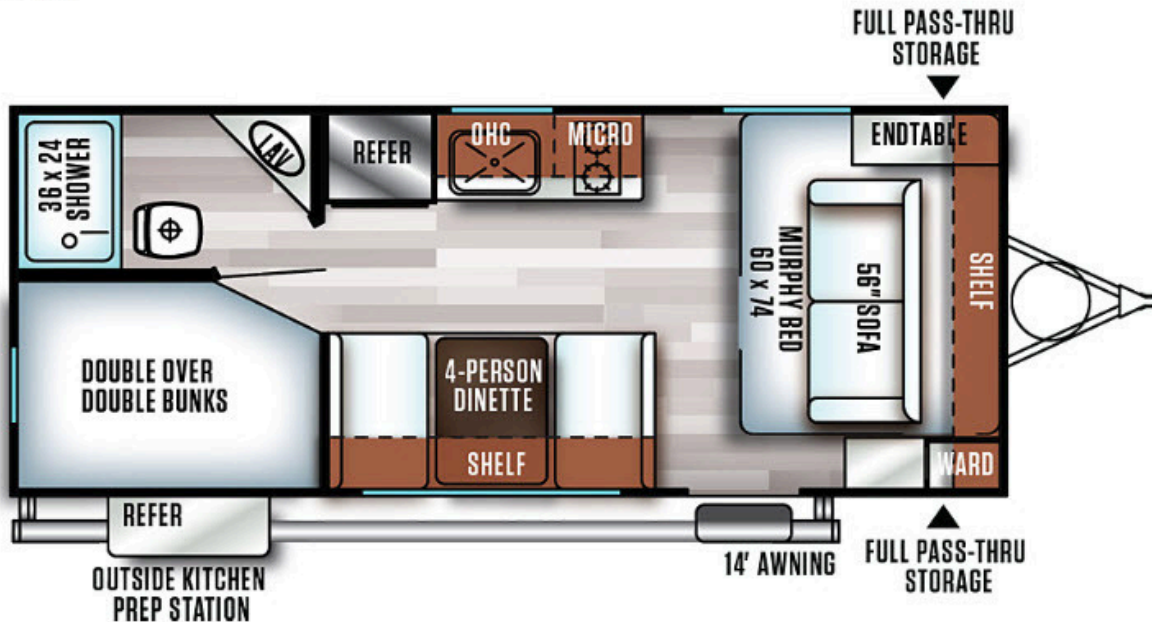

## GENERAL INFORMATION

**MAKE:** Forest River

**LENGTH:** 22.5ft

**MODEL:** Salem FSX 179DBK

**WIDTH:** 7.5ft

**YEAR:** 2019

**HEIGHT:** 10.17ft

## TOWING INFORMATION

**DRY WEIGHT:** 3224lbs

**HITCH SIZE:** 2 5/16

**PAYLOAD CAPACITY:** 756lbs

**LIGHT CONNECTION:** 7 Round

**GVWR:** 3980lbs

**BRAKE CONTROLLER:** Needed

## UTILITY HOOKUPS

**ELECTRICAL:** 30 and 50 AMP

**WATER:** Tank and Hose

**SEWER:** Tank and Dump Hose

**PROPANE:** Attached to Hitch





# CLIPPER 17BH



**DAILY: \$115**  
**WEEKEND: \$175**  
**HOLIDAY: \$230**

# CLIPPER 17BH

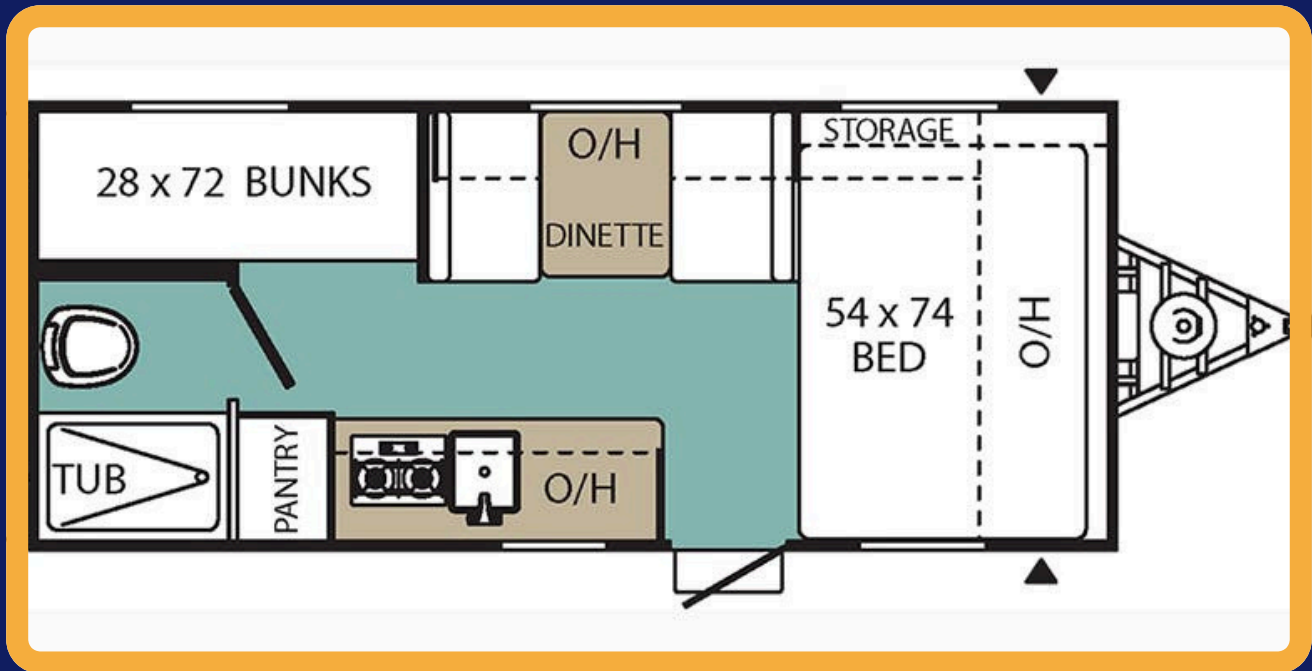

## GENERAL INFORMATION

**MAKE:** Coachmen

**LENGTH:** 20.4ft

**MODEL:** Clipper 17BH

**WIDTH:** 7.5ft

**YEAR:** 2022

**HEIGHT:** 10ft

## TOWING INFORMATION

**DRY WEIGHT:** 3014lbs

**HITCH SIZE:** 2 5/16

**PAYLOAD CAPACITY:** 826lbs

**LIGHT CONNECTION:** 7 Round

**GVWR:** 3840lbs

**BRAKE CONTROLLER:** Needed

## UTILITY HOOKUPS

**ELECTRICAL:** 30 and 50 AMP

**WATER:** Tank and Hose

**SEWER:** Tank and Dump Hose

**PROPANE:** Attached to Hitch





# CATALINA 164BH



**DAILY: \$115**  
**WEEKEND: \$175**  
**HOLIDAY: \$230**



# CATALINA 164BH

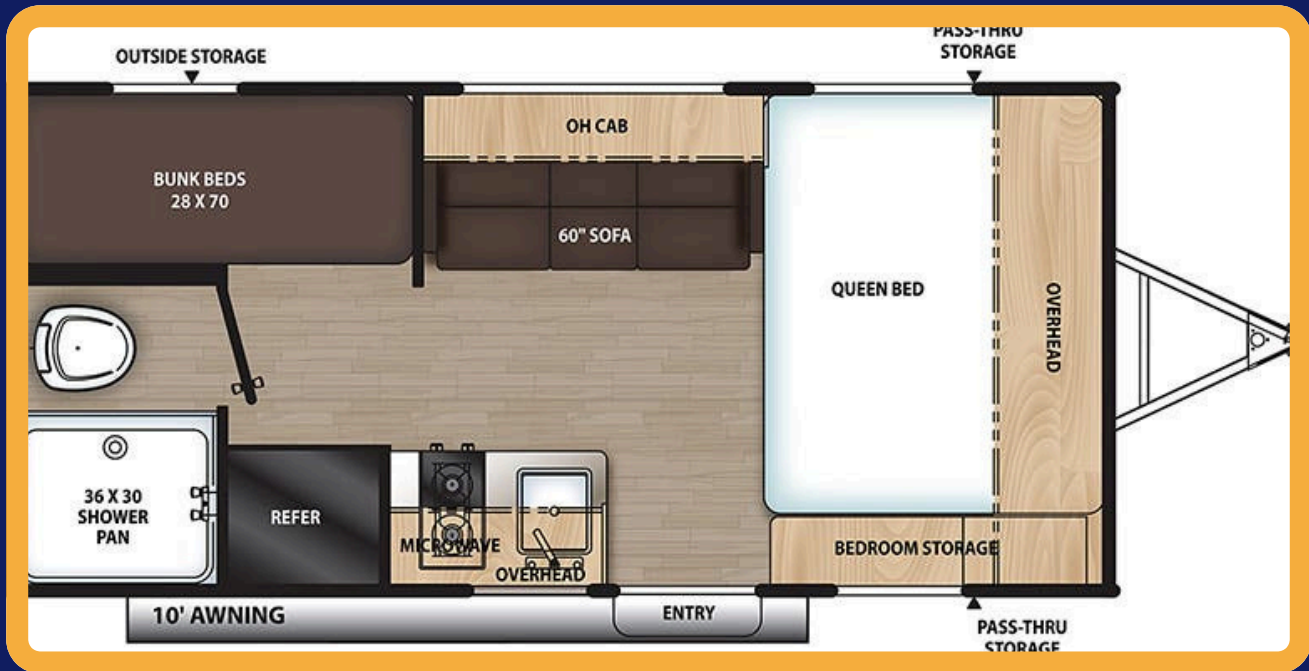

## GENERAL INFORMATION

**MAKE:** Coachmen

**LENGTH:** 19.5ft

**MODEL:** Catalina 164BH

**WIDTH:** 7.5ft

**YEAR:** 2023

**HEIGHT:** 10.08ft

## TOWING INFORMATION

**DRY WEIGHT:** 3046lbs

**HITCH SIZE:** 2 5/16

**PAYLOAD CAPACITY:** 1340lbs

**LIGHT CONNECTION:** 7 Round

**GVWR:** 4386lbs

**BRAKE CONTROLLER:** Needed

## UTILITY HOOKUPS

**ELECTRICAL:** 30 and 50 AMP

**WATER:** Tank and Hose

**SEWER:** Tank and Dump Hose

**PROPANE:** Attached to Hitch